

Right click on the „Internet Access” and choose the „Open Network and Sharing Center”.

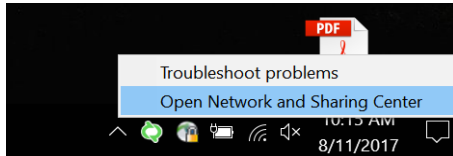

Choose the „Set up a new connection or network”

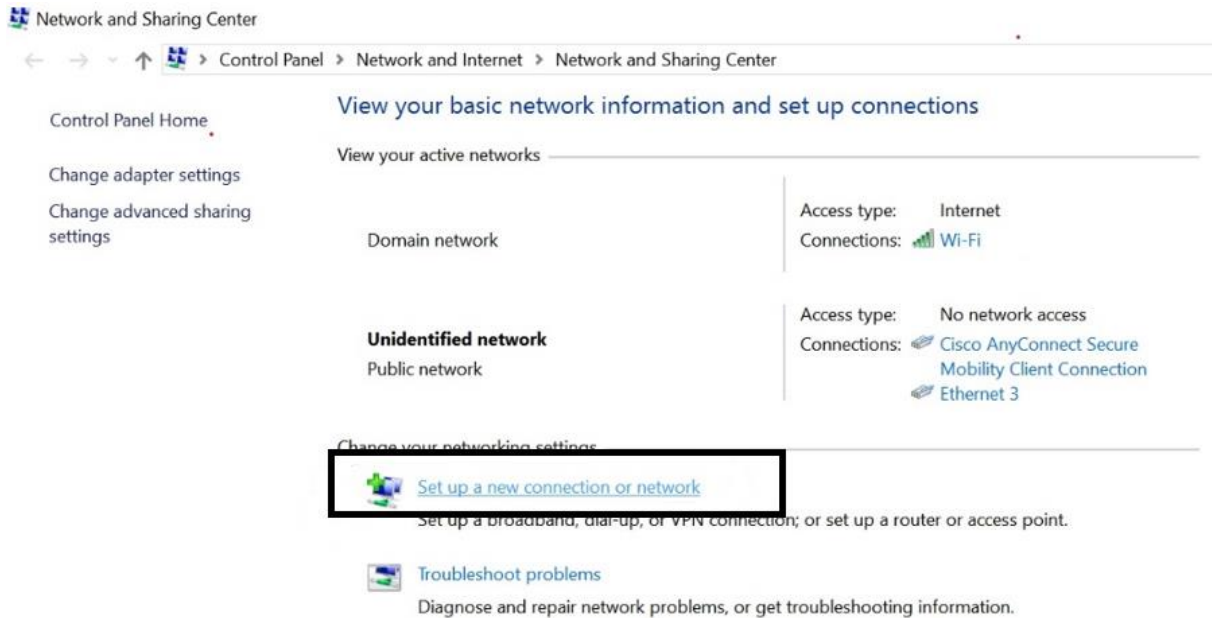

Choose the „Manually connect to a wireless network” and click on „Next”.

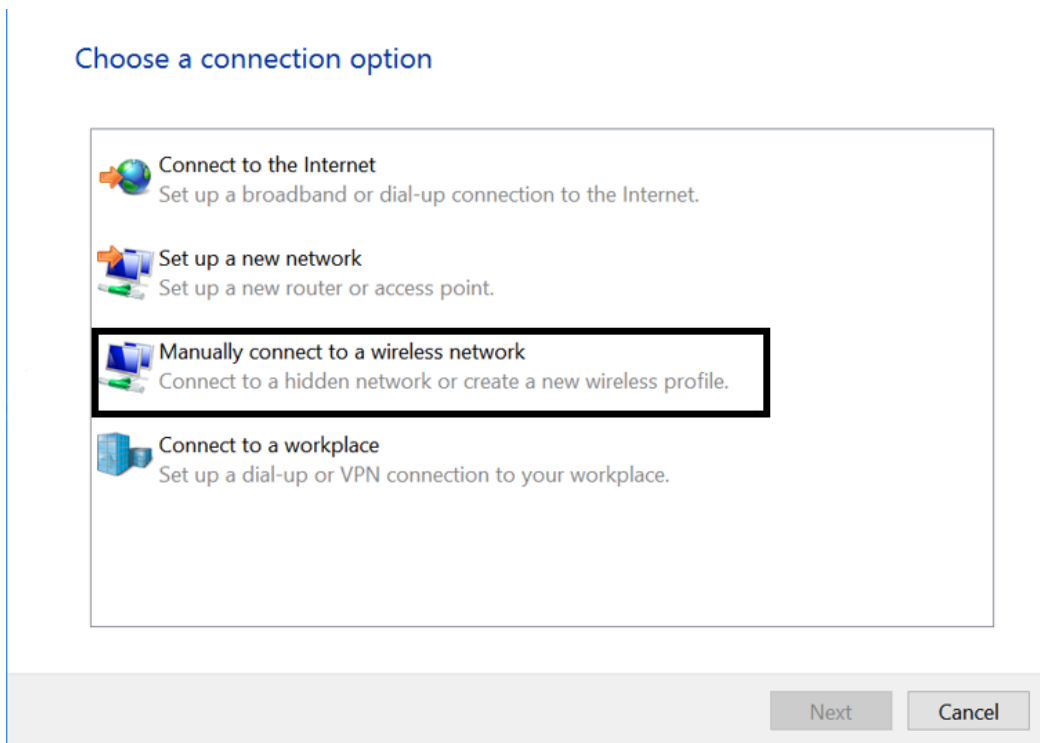

Adjust it based on the image and click on „Next”.

← Manually connect to a wireless network

Enter information for the wireless network you want to add

Network name:

Security type:

Encryption type:

Security Key: Hide characters

Start this connection automatically

Connect even if the network is not broadcasting

Warning: If you select this option, your computer's privacy might be at risk.

Before closing this window click on „Change connection settings”.

← Manually connect to a wireless network

Successfully added ETRC

[→ Change connection settings](#)
Open the connection properties so that I can change the settings.

Choose the „Security” tab and click on „Settings”.

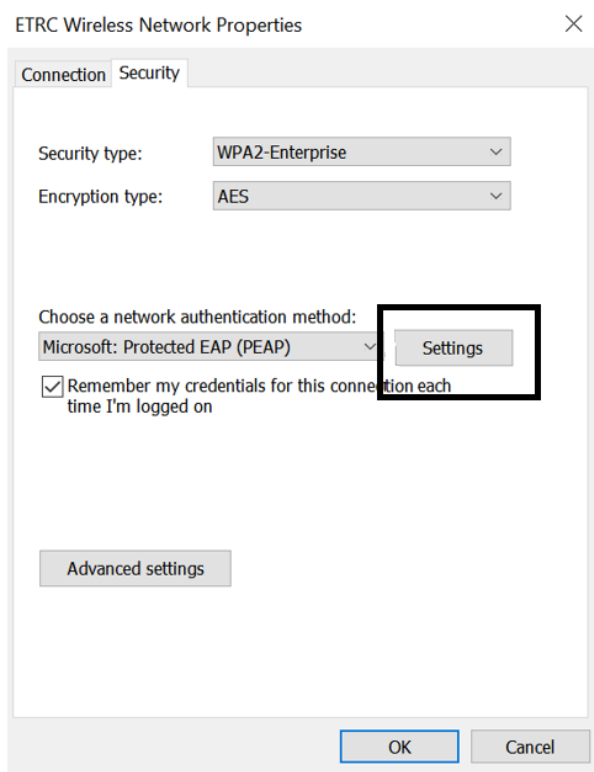

Don't use „Verify the server's identity by validating the certificate”

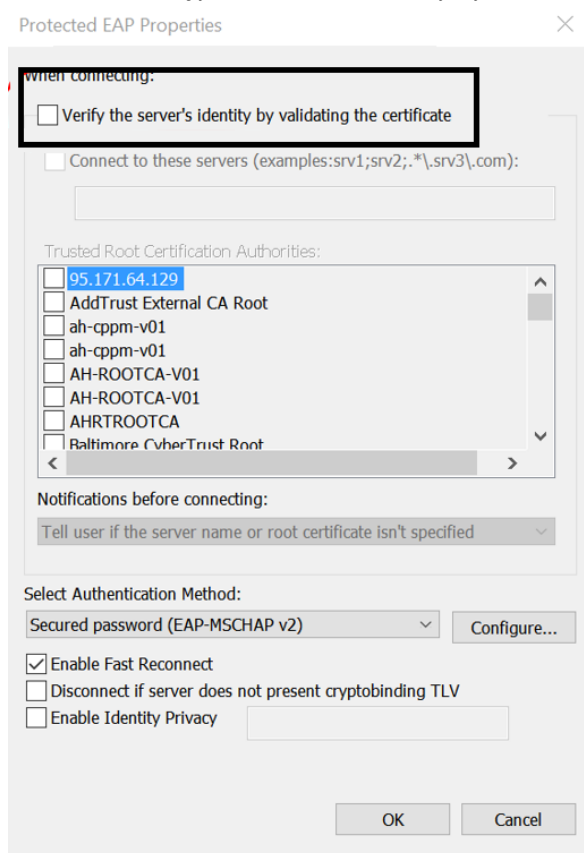

Click on „Configure...”

When connecting:

Verify the server's identity by validating the certificate

Connect to these servers (examples: srv1; srv2; *\.srv3\com):

Trusted Root Certification Authorities:

- 95.171.64.129
- AddTrust External CA Root
- ah-cppm-v01
- ah-cppm-v01
- AH-ROOTCA-V01
- AH-ROOTCA-V01
- AHRTRootCA
- Baltimore CyberTrust Root

Notifications before connecting:

Tell user if the server name or root certificate isn't specified

Select Authentication Method:

Secured password (EAP-MSCHAP v2) **Configure...**

Enable Fast Reconnect

Disconnect if server does not present cryptobinding TLV

Enable Identity Privacy

OK Cancel

Don't use „Automatically use my Windows logon name and password (and domain if any)”

EAP MSCHAPv2 Properties

When connecting:

Automatically use my Windows logon name and password (and domain if any).

OK Cancel

Click on „Advanced settings”

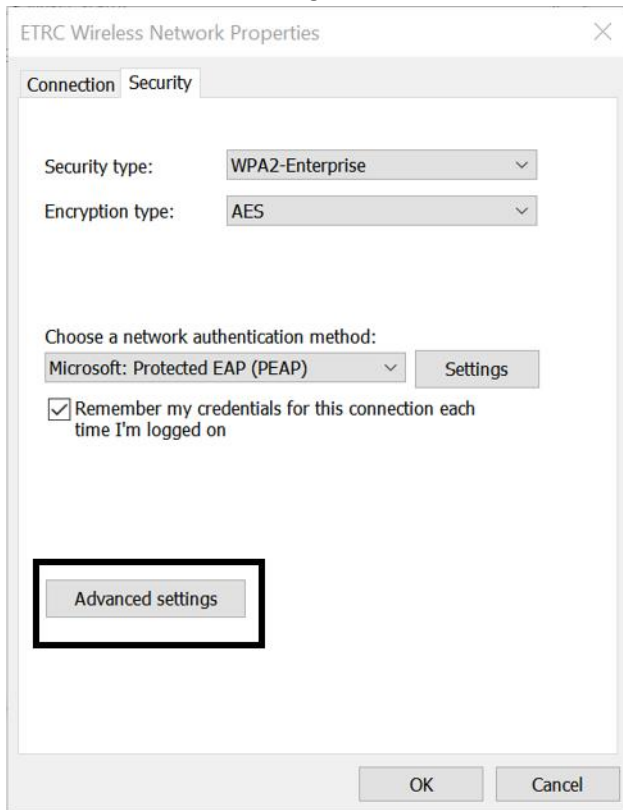

On the „802.1X settings” tab use „Specify authentication mode” with „User or computer authentication”.

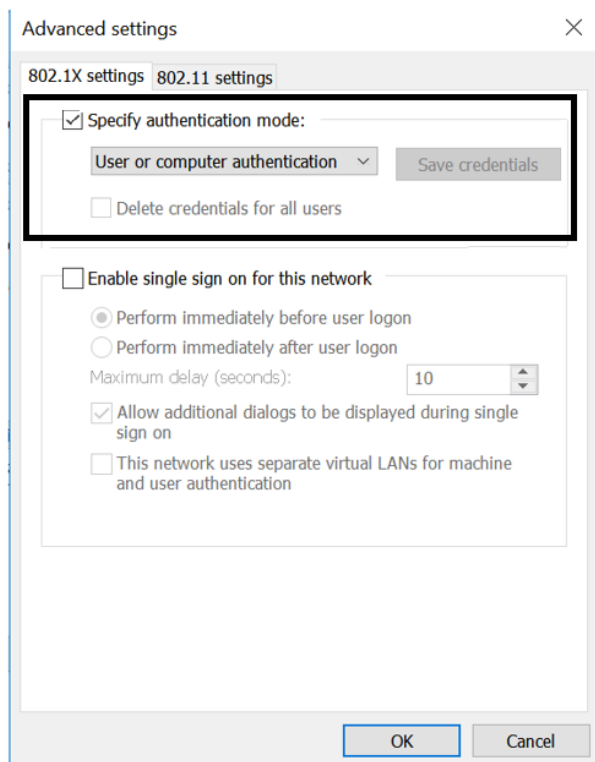

Click on „Ok” and you finally set your network connection.